



Hand stamps

Solutions of
fascinating quality



	Models	Page
Automatic Numbering Machines	H52, H56	4
	H57, H55, H16	5
Number Stamp	H4	6
Date Numberer	H18	6
Numberer with Textplate	H67b	7
Numberers with Date and Textplate	H38b, H37b	7
	DN65a	8
Date Stamps	H42/H42S	8
Date Stamps with Textplate	H49b, H43, H44	9
Mail Date Stamp and Ink pad	P1, 12	10
Mail Roller Dater	P2	10
Clock Time Stamp	timeStamp 131	11
Electric Stamp with Textplate	MiniPrinter	12
Inks		13
Ink Supply Systems	Colormatic	13
	Ink pad	13
Spare Parts		14

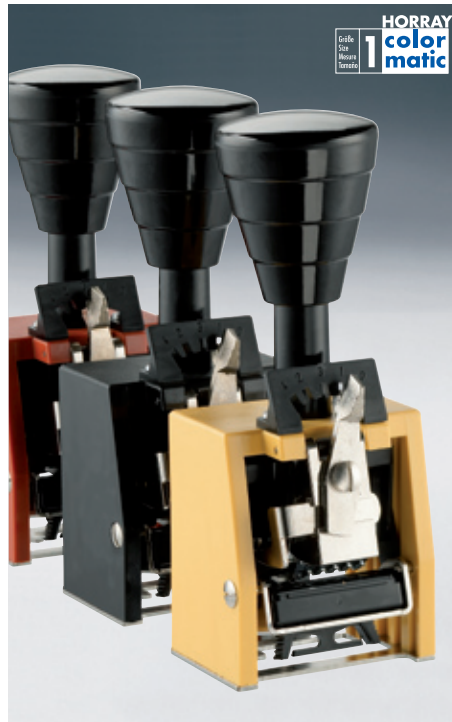

Description	
Frame:	
Number of wheels:	
Figure size:	
Automatic action:	
Textplate:	
Figure style:	
Ink pad:	
Net weight:	
Special features:	

H52	
Frame:	Plastic, black, red, yellow
Number of wheels:	6 alloy wheels, sinkable zero
Figure size:	3.5 mm, 4.5 mm or 5.5 mm
Automatic action:	0x, 1-4x
Textplate:	-
Figure style:	Antique or Block
Ink pad:	Horray Colormatic 1, black or red
Net weight:	310 g
Special features:	- Also available Arabic and Iranian figures - 4 wheels with automatic action

H56	
Frame:	Nickelled and highly finished
Number of wheels:	6 wheels of special alloy, print with and without preceding zeros
Figure size:	4.5 mm or 5.5 mm
Automatic action:	0x, 1-6x, 12x, 20x
Textplate:	-
Figure style:	Antique or Block
Ink pad:	Horray Colormatic 2, black or red
Net weight:	360 g
Special features:	- Also available Arabic and Iranian figures - 5 wheels with automatic action

Sample prints	mm
01 1 2 3 4 5 6	3.5
02 123456	4.5
03 123456	5.5
04 1 2 3 4 5 6	3.5
05 123456	4.5
06 123456	5.5
07 ۱۲۳۴۵۶	5.5
08 ۱۲۳۴۵۶	5.5

Sample prints	mm
09 123456	4.5
10 123456	5.5
11 123456	4.5
12 123456	5.5
13 ۵۶۷۸۹۰	5.5
14 ۱۲۳۴۵۶	5.5



H57	
Plastic, black	
6 wheels of special alloy, print with and without preceding zeros	
4.5 mm or 5.5 mm	
0x, 1–6x, 12x, 20x	
-	
Antique or Block	
Horray Colormatic 2, black or red	
260 g	
- Also available Arabic and Iranian figures - 5 wheels with automatic action	

Sample prints	mm
15 123456	4,5
16 123456	5,5
17 123456	4,5
18 123456	5,5
19 ۰۶۷۸۹۰	5,5
20 ۱۲۳۴۵۶	5,5



H55	
Nickelled and highly finished	
6 wheels of special alloy, sinkable zeros	
3.5 mm, 4.5 mm or 5.5 mm	
0x, 1–4x	
-	
Antique or Block	
Horray Colormatic 1, black or red	
490 g	
- Also available Arabic and Iranian figures - 4 wheels with automatic action	

Sample prints	mm
21 1 2 3 4 5 6	3.5
22 123456	4.5
23 123456	5.5
24 1 2 3 4 5 6	3.5
25 123456	4.5
26 123456	5.5
27 ۱۲۳۴۵۶	5.5
28 ۱۲۳۴۵۶	5.5



H16	
Nickelled and highly finished	
7 or more wheels of special alloy, sinkable zeros	
3.5 mm, 4.5 mm or 5.5 mm	
0x, 1–4x	
-	
Antique or Block	
Horray Colormatic 1, black or red or pre-inked pad incl. pad holder	
470 g	
- Also available Arabic and Iranian figures - 4 wheels with automatic action	

Sample prints	mm
29 1 2 3 4 5 6 7 8 9 0	3.5
30 1234567890	4.5
31 1234567890	5.5
32 1 2 3 4 5 6 7 8 9	3.5
33 1234567890	4.5
34 1234567890	5.5
35* AE 123456	
36* 234/5678	

* Special arrangements at extra charge



Description
Frame:
Number of wheels:
Figure size:
Automatic action:
Textplate:
Figure style number:
Figure style date:
Ink pad:
Net weight:
Special features:

H4
Nickelled and highly finished
6 and more wheels of special alloy
3.5 mm, 4.5 mm or 5.5 mm
-
-
Antique or Block
-
Horray Colormatic 1, black or red or pre-inked pad incl. pad holder
360 g
- Set by stylo, rotate in either direction - Wheels with 12 fields (0 to 9, hyphen, blank) - Letters and figures can be engraved on every wheel

H18
Nickelled and highly finished
6 wheels of special alloy, sinkable zero
3.5 mm, 4.5 mm or 5.5 mm
0x, 1-4x
-
Antique or Block
Block, abbreviated months, year in full
Pre-inked pad incl. pad holder
620 g
- Date right or left, set by stylo - Months in many languages - 4 wheels with automatic action

Sample prints	mm
37 123456	3.5
38 567890	5.5
39* 45 12 Z/	
40* 34 3a 7 6	

* Special arrangements at extra charge

Sample prints	mm
41 123456 *20.FEB.15	3.5
42 20. JAN. 2016 *123456	4.5
43 123456 *20. JAN. 2014	5.5
44 30.09.13*123456	5.5



H67b
Nickelled and highly finished
6 wheels of special alloy
4.0 mm
0x, 1x, 2x, instead of 2x are 3x or 4x repetitions possible
Brass: 45 x 25 mm, Nyloprint: 43 x 25 mm
Antique or Block
-
Pre-inked pad incl. pad holder
450 g
- 4 wheels with automatic action

H38b
Nickelled and highly finished
5 wheels of special alloy
4.0 mm
0x, 1x, 2x, instead of 2x are 3x or 4x repetitions possible
Brass: 45 x 25 mm, Nyloprint: 43 x 25 mm
Antique or Block
Block, abbreviated year, also with ISO-Date
Pre-inked pad incl. pad holder
470 g
- 4 wheels with automatic action
- Date left or right, setting by thumb lever
- Date and number exchangeable

H37b
Nickelled and highly finished
5 (6) wheels of special alloy
4.0 mm
0x, 1x, 2x, instead of 2x are 3x, 4x, 5x or 6x repetitions possible
Brass: 50 x 30 mm, Nyloprint: 49 x 28 mm
Antique or Block
Block, abbreviated year, also with ISO-Date
Horray Colormatic 4, black or red or pre-inked pad incl. pad holder
650 g
- 4 wheels with automatic action
- Date left or right, setting by thumb lever
- Date and number exchangeable

Sample prints mm

45 45 x 25



Sample prints mm

47 45 x 25

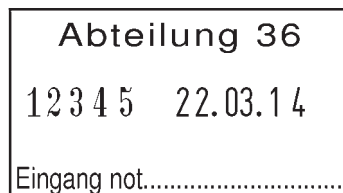

Sample prints mm

49 50 x 30

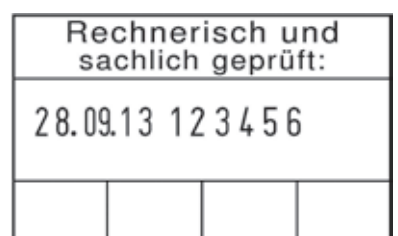

46

Gebiet			
123456			
Depot		Nachnahme	

48

TOTOGOL
COSTA RICA
23.03.13 2345
Sellador No. 210

50 50 x 30

TORKONTROLLE			
123456 28.07.15			
Werk I	Werk II	Werk III	Werk IV

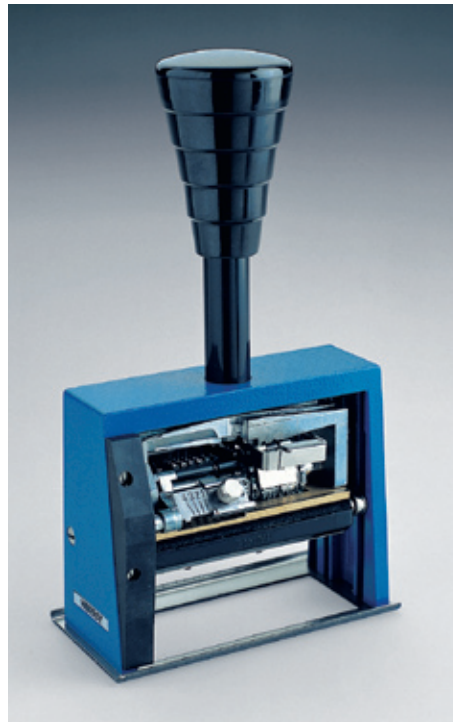

Description	
Frame:	
Number of wheels:	
Figure size:	
Automatic action:	
Textplate:	
Figure style number:	
Figure style date:	
Ink pad:	
Net weight:	
Special features:	

DN65a	
Frame:	Metal frame of magnesium, blue
Number of wheels:	6 wheels of special alloy
Figure size:	4.0 mm
Automatic action:	0x, 1-4x
Textplate:	Brass: 65 x 30 mm
Figure style number:	Antique or Block
Figure style date:	Block, date in figures or with abbreviated months, years in full
Ink pad:	Pre-inked pad incl. pad holder
Net weight:	600 g
Special features:	- Date is set by thumb lever - 4 wheels with automatic action

H42/H42S	
Frame:	Nickelled and highly finished
Number of wheels:	Wheels of special alloy
Figure size:	4.0 mm
Automatic action:	Thumb key
Textplate:	H42S with engraving bridge: 29 x 5 mm
Figure style number:	-
Figure style date:	Block, date in figures or with abbreviated months
Ink pad:	Pre-inked pad incl. pad holder
Net weight:	H42: 250 g, H42S: 260 g
Special features:	- Date is set by thumb lever

Sample prints mm

51 65 x 30

Aareon									
5 6 7 8 9 0					0 8 . FEB . 20 1 3				
Nr.									

Bürgermeisteramt Radolfzell am Bodensee - Poststelle -									
0 1 2 3 4 5					2 6 . 0 4 . 1 6				
10	105	230	231	350	351	352			360
20	202	203	204	205	230	231	232	233	
A	AB	ABC	ABCD	A1	A2	A3	A4	A5	

Sample prints mm

52 05. JAN. 2014 4.0

53 26. IV. 2013 4.0

54 08. SEP. 13 4.0

55 2016 -03-25 4.0

56 13-09-24 4.0

57 07.05.13 4.0

58* Eingang 4.0
13. JAN. 2015 25 x 12

*model H42S

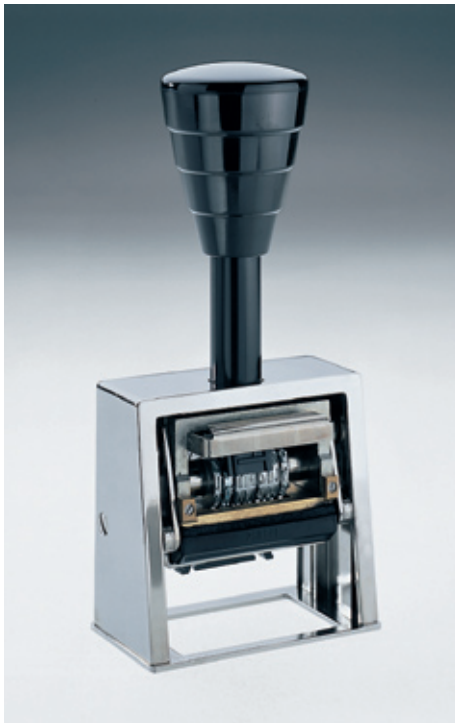

H49b
Nickelled and highly finished
Wheels of special alloy
4.0 mm
Thumb key
Brass: 45 x 25 mm, Nyloprint: 43 x 25 mm
-
Block, with abbreviated months, years in full or abbreviated
Pre-inked pad incl. pad holder
450 g
- Date is set by thumb lever

H43
Plastic, ruby coloured
Wheels of Delrin
4.0 mm
Thumb key
Delrin: 35 x 25 mm
-
Block, date in figures
Pre-inked pad incl. pad holder
152 g
- Date is set by thumb lever

H44
Plastic, blue
Wheels of special alloy
4.0 mm
-
Brass: 17 x 25 mm or 25 mm Ø
-
Block, months in many languages, also with ISO-Date
Pre-inked pad incl. pad holder
250 g
- Date wheels are stylo-set
- Round textplate

Sample print mm

59 45 x 25



Sample prints mm

60 35 x 25

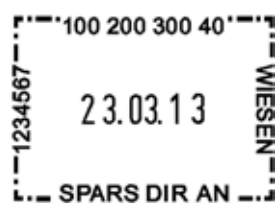

61 35 x 25

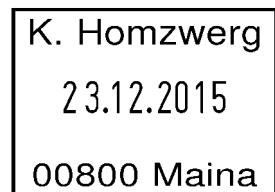

Sample prints mm

62 17 x 25

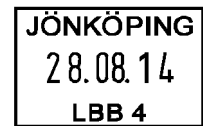

63 Ø 25



64 Ø 25





Description

Figure size:

Textplate:

Figure style date:

Ink pad:

Net weight:

Special features:

P1, 12*

3.0 mm

Textplate with 30 mm, 35 mm and 40 mm head diameter

Block, various dates available

Hand inking by separate ink pad

200 g

- Print head made of one entire piece of hardenable steel
- Solidly built
- If required with hour wheels

P2

3.0 mm

Diameter of postmark 29 mm max., unengraved

Block, various dates available

Self-inking by built in ink roller

400 g

- Wheels and print barrel made from steel
- Roller engraved with wavy lines

Sample prints

mm

65



Ø 30

66



Ø 35

Sample print

67



* Ink pad, used with dater model P1, Plastic case with cover, Ø 135 mm.



Description
Figure size:
Textplate:
Figure style date:
Ink pad:
Net weight:
Special features:

timeStamp 131
3.5 mm
One line printing, print width max. 40 mm
Block
Ribbon cassette
2000 g
The compact modern electric stamp. Simple to use, the timeStamp 131 optimises workflow where recording of dates, times and numbers is important.
<ul style="list-style-type: none"> - Multifunctional LC-display of weekday, date, hour, minute - Fast single line print - Adjustable trigger switch - Password security - 12 months guarantee
<ul style="list-style-type: none"> - Time formats: 12 or 24 hours and 60 or 100 minute hours - Prints through up to 3 copies - Easily programmable settings - Wall mounting possible

Sample prints

68

21 JAN 2015 PM1:19	ERHAL 12 FEB 2015
21 ENE 2015 PAG	RCVD FEB 12 2015
23 AOU 2015 PAYÉ	19 JUL 2015 00000016
AUG 23 2015 PAID	2015 JUL 19 00000045
ME, 18 MAR 2015	19-7-2015 13:47
SA, 15 13:30	00000022
2015 DEC 20 13:31:45	00000025 15 JUL 19 13:58:13
2015 JUL 12 13:37	00000028 15 JUL 19 13:58
12 FEV 2015 13:40	00000043 JUL 19 14:00

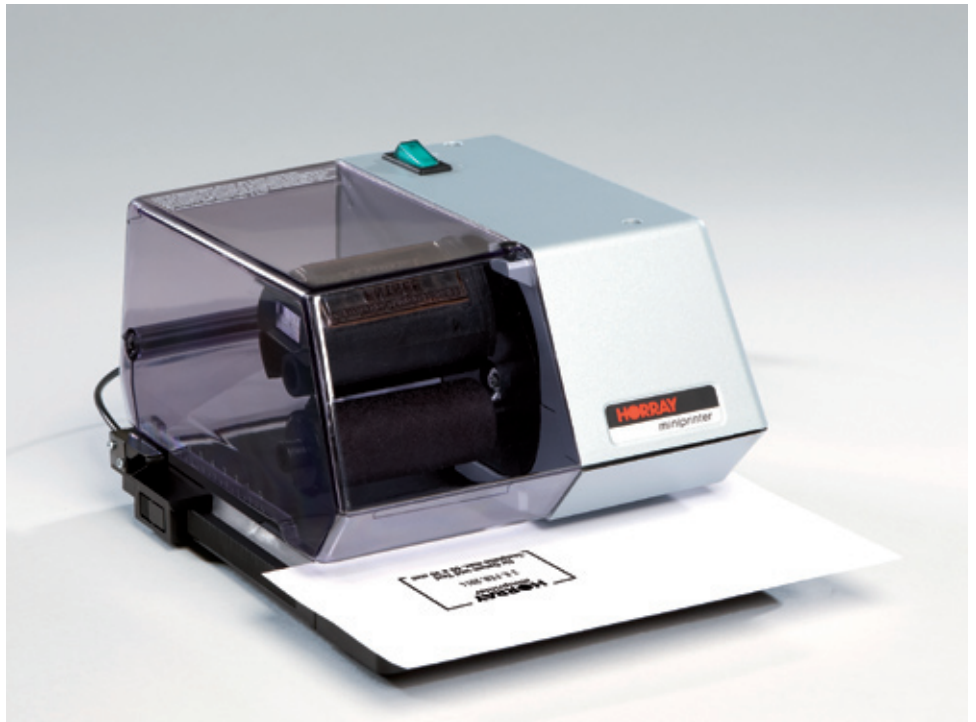

Description

Figure size:

Textplate:

Figure style date:

Ink pad:

Net weight:

Special features:

MiniPrinter

4.0 mm

Textplate up to 60 x 35 mm

Block style

One-way microporous inking roll

2400 g

Quiet, reliable and versatile - the MiniPrinter is the best way to speed through post-room and accounts department stamping jobs. The MiniPrinter is especially useful if varying thicknesses of document or form set must be marked.

- Easy transformation to date without text, date with text or only text
- Documents up to A 5 size can be marked on all spots
- Max. thickness of paperwork 5 mm
- Exact positioning of prints supported by transparent hood

Sample prints

mm

69

60 x 35



70

49 x 32





Ink for Metal Stamps

For all Horray metal stamps we recommend to use our special oil based ink.

Available

- in transparent boxes of 12 tubes, of 15 ml colors: black or red

- or in bottles of 45 ml or 500 ml colors: black, red, blue, green

Quick Drying Inks

Suitable for metal stamps and solvent resistant dies. Used on non-absorbent surfaces, such as metal, coated papers, plotter prints, tracing paper, many plastics, and foils such as coated polyethylene (PE).

R 2021	black	45 ml 500 ml
R 3023*	black	45 ml 500 ml

* Light- and weatherproof, non-toxic.

Thinner for Quick Drying Inks

R 2530	45 ml 500 ml
--------	-----------------

Colormatic

Size **1** **HORRAY color matic**

Models
H16
H52
H55

Ink
black or
red

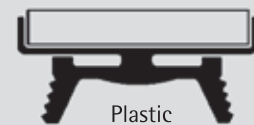

Size **2** **HORRAY color matic**

Models
H56
H57

Ink
black or
red

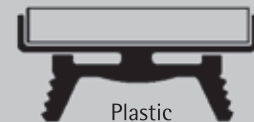

Size **4** **HORRAY color matic**

Models
H37b

Ink
black or
red

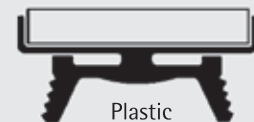

Ink pad

Models	Ref.No.	Pad holder	Length of felt pad	Inner frame width
H4	10 098	39.0 x 22.0 mm	29.5 mm	35.0 mm
H18 (H17)	13 053	43.3 x 22.8 mm	41.5 mm	40.0 mm
H16 (H15)	17 253	53.0 x 22.8 mm	51.5 mm	50.0 mm
	30 053	63.0 x 22.8 mm	61.5 mm	60.0 mm
	30 153	78.0 x 22.8 mm	76.5 mm	75.0 mm

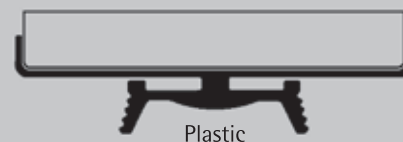

Models	Ref.No.	Pad holder	Length of felt pad	Inner frame width
H67b	250 041	47.2 x 29.0 mm	47.5 mm	40.0 mm
H38b	250 041	47.2 x 29.0 mm	47.5 mm	40.0 mm
H49b	250 041	47.2 x 29.0 mm	47.5 mm	40.0 mm
DN65a	231 091	76.0 x 34.0 mm	75.0 mm	

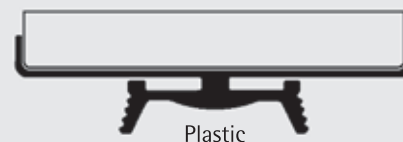

Models	Ref.No.	Pad holder	Length of felt pad	Inner frame width
H42	221 026	31.8 x 20.0 mm	30.5 mm	28.0 mm
H42S	221 542	31.8 x 20.0 mm	30.5 mm	28.0 mm
H43 (H45)	221 047	35.8 x 30.0 mm	36.0 mm	28.0 mm



Please, state print width and figure size.

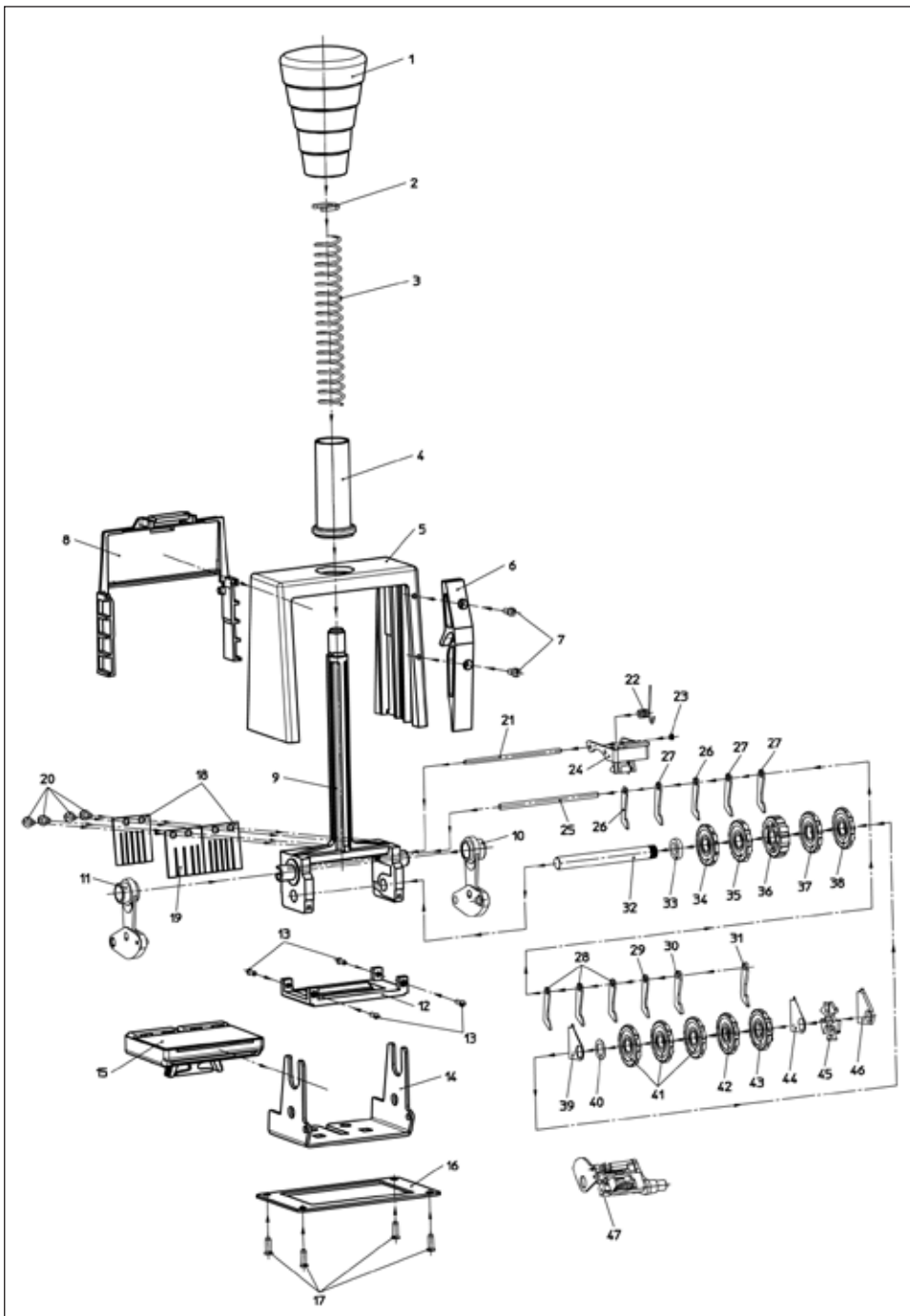

1. Handle
2. Stop-bolt with washer
3. Handle spring
4. Spring tube
5. Frame
6. Number change mechanism
7. Screws M2,6x6
8. Plate
9. Wheel case (box), complete
10. Side-articulation right, complete
11. Side-articulation left, complete
12. Face-plate
13. Face-plate screw
14. Inking-pad case holder
15. Inking-pad / Inking-pad case
16. Base-plate
17. Screw for line-marker/Screw for base-plate
18. Comb-spring 1 tooth number
19. Comb-spring wide for date
20. Screw for comb-spring
21. Shaft thumb lever
22. Front-lever spring
23. Ring
24. Front-lever Front-pawl for date
Front-pawl spring
25. Axle of back-pawls
26. Back pawl V 12TL
27. Back pawl V 10TL
28. Back pawl V 10TL
29. Back pawl 2nd-5th wheel
30. Back pawl 1st wheel
31. Back pawl 2 & 4 times pawl disc
32. Wheel axle
33. Washer, small
34. Day-tenth wheel 1 2 3 -
35. Day-unit wheel 0. to 9.
36. Month wheel
37. Year wheel 200 201 etc.
38. Year wheel 0 to 9
39. Washer, large
40. Disc 6, 1X10X0,2
41. 3rd to 6th wheel
42. 2nd numbering wheel
43. 1st wheel 0 to 9
44. Washer, large
45. Pawl-disc 2 times
46. Washer, large
47. Beam mechanism



Horray – fascinatingly precise solutions

Do you know the fascination that accompanies mechanical watches of highly regarded manufacturers? Outstanding features of these masterpieces are quality and precision that guarantee long service life.

The same applies to the hand stamps made by Horray! The precision engineering products company, founded in 1932 by Karl Horray, has developed to become a reputable specialist for metal hand stamps. Since 1983, Horray has been a member of the Reiner group of companies.

Horray hand and electric stamps fulfill the highest standards. We also offer solutions for your individual stamp requirements.

Just convince yourself!

Full service inclusive of...

We offer full service whenever a stamp is involved: metal stamps, electric stamps, special models, metal stamp inks or spare parts.

Horray offers decades of experience in high-quality stamp solutions.

Best quality and on time delivery is what we are known for. Just test us.

www.horray.de

Guarantee

HORRAY machines are precision engineered products, developed on the basis of more than 70 years of experience.

For all machines included in this catalogue we guarantee solid construction, first class material, and finest workmanship. During two year from date of purchase, any malfunction or defect in material will be eliminated free of charge. Normal wear and damage due to the use of the machine, soiling, and inking with improper ink are excluded from this guarantee.

K. Homzweg
23.12.2015
00800 Maina

1234567890

Gebiet			
123456			
Depot		Nachnahme	

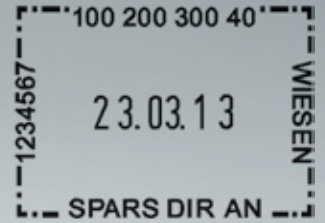

05. JAN. 2014

TORKONTROLLE			
123456 28.07.15			
Werk I	Werk II	Werk III	Werk IV

۱۲۳۴۵۶

234/5678

123456 * 20.FEB.15

HORRAY
FEINMECHANIK & ELEKTRONIK

www.horray.de